



# County Islands Annexation Island No. LH-5 & LH-6 Sewer Plan

## LEGEND

--- EXISTING SEWER

- LOTS WITHIN 200 FEET OF A PUBLIC SEWER LINE.
- LH-5 (CYPRESS/ TERRY ISLAND): 5 OF THE 7 LOTS OR 71.4% ARE WITHIN 200 FEET OF A PUBLIC SEWER LINE.
- LH-6 (HENSEL/MAGDA ISLAND): 5 OF THE 49 LOTS OR 10.2% ARE WITHIN 200 FEET OF A PUBLIC SEWER LINE.

PREPARED BY: C.K.  
DATE: 05-18-2017  
SHEET 7 OF 12

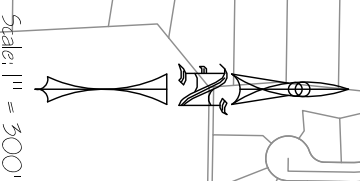
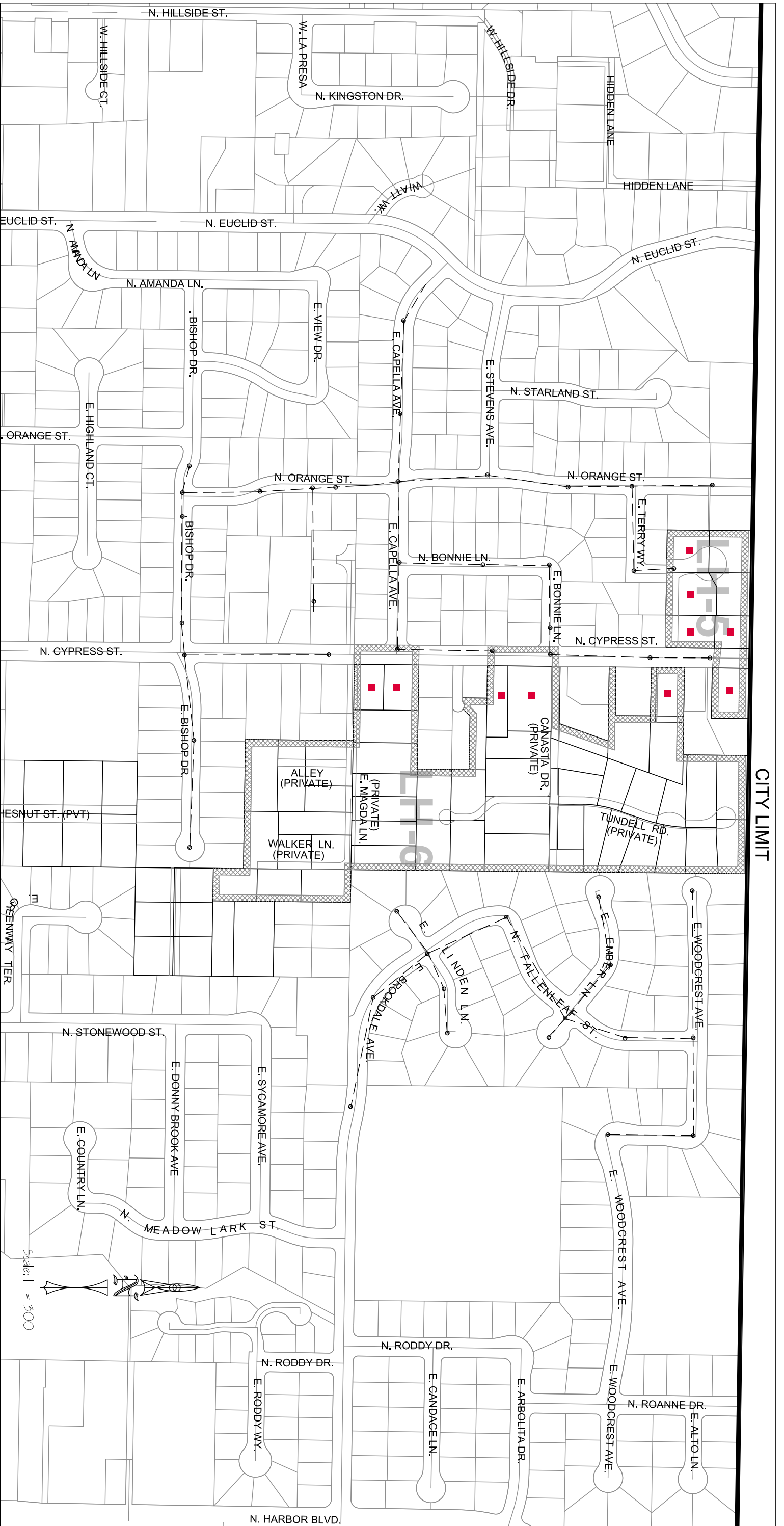



# County Islands Annexation

## Island No. LH-8

### Sewer Plan

#### LEGEND

--- EXISTING SEWER



■ LOTS WITHIN 200 FEET OF A PUBLIC SEWER LINE.

LH-8 (PALM/SHADYCREST ISLAND): 7 OF THE 17 LOTS OR 41.1% ARE WITHIN 200 FEET OF A PUBLIC SEWER LINE.





# County Islands Annexation Island No. LH-3 & LH-4 Sewer Plan



## LEGEND

- EXISTING SEWER
- PROPOSED SEWER
- SEWER CLEAN OUT
- SEWER MANHOLE
- LOTS WITHIN 200 FEET OF A PUBLIC SEWER LINE:  
LH3 (CITRUS/ IDAHO ISLAND): 23 OF THE 37 LOTS OR 62.1% ARE WITHIN 200 FEET OF A PUBLIC SEWER LINE.
- LOTS WITHIN 200 FEET OF A PUBLIC SEWER LINE:  
LH4 (CITRUS/ ENTRADA ISLAND): 2 OF THE 4 LOTS OR 50% ARE WITHIN 200 FEET OF A PUBLIC SEWER LINE.
- SEWER LATERAL (4")
- SEWER LATERAL (6")

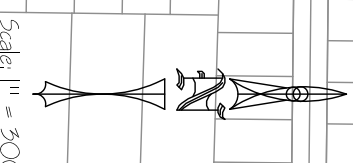

PREPARED BY: C.K.  
DATE: 05-18-2017  
SHEET 6 OF 12



**County Islands Annexation  
Island No. LH-1  
Sewer Plan**

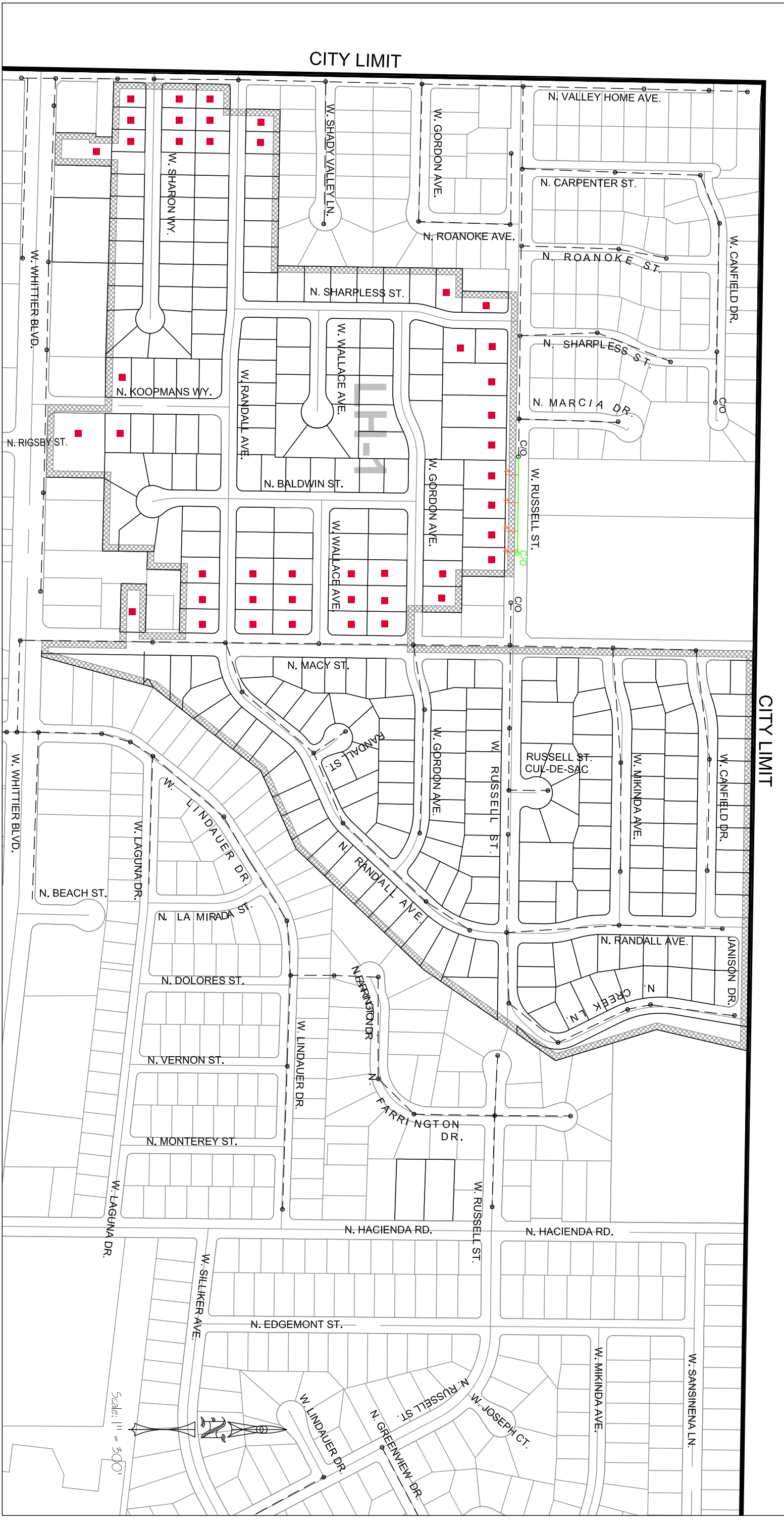

**LEGEND**

- EXISTING SEWER
- PROPOSED SEWER
- 4 SEWER LATERAL (4")
- 6 SEWER LATERAL (6")
- C/O SEWER CLEAN OUT
- MH SEWER MANHOLE
- LOTS WITHIN 200 FEET OF A PUBLIC SEWER LINE. 44 OF 143 OR 30.8% OF THE LOTS WEST OF MACY ARE WITHIN 200 FEET OF A PUBLIC SEWER LINE.

